

Surface Mounted Flush Condition

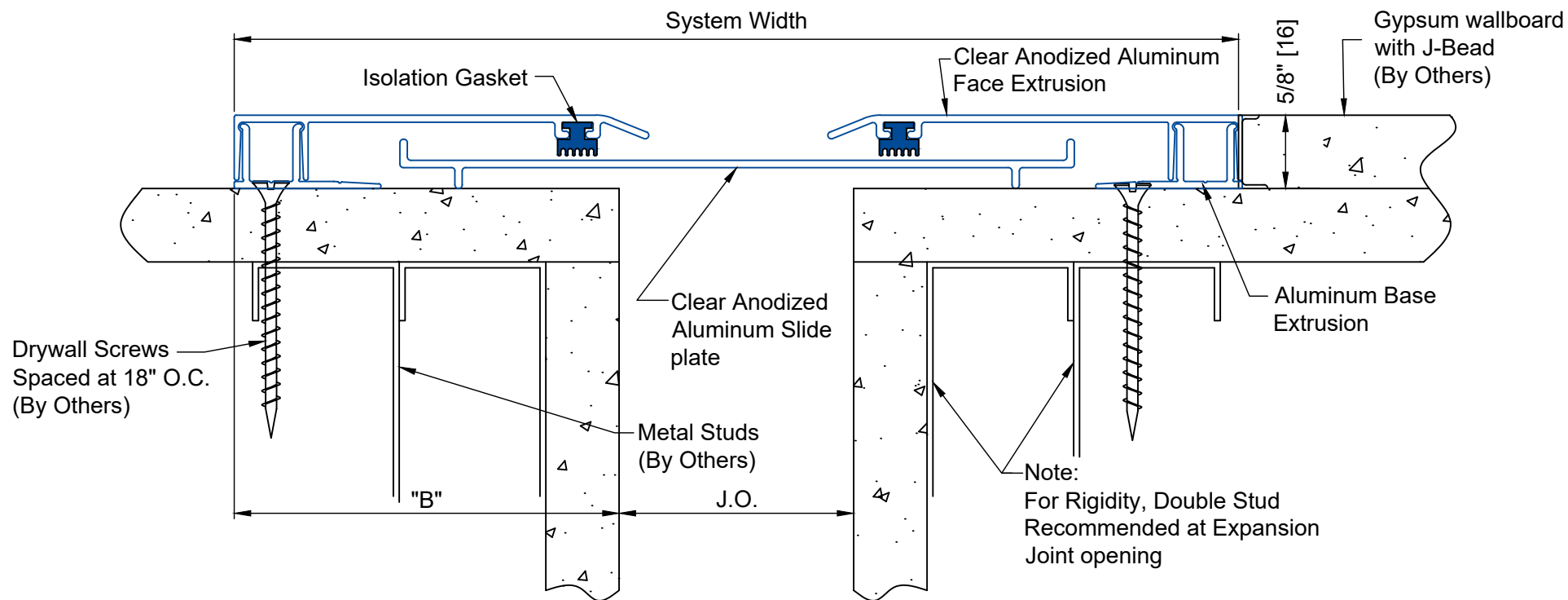

CTR-100 THRU CTR-300 DETAIL WALL-TO-WALL CONDITION

() - Denotes Millimeters

DIMENSION CHART

Model	J.O. @ Min.	J.O. @ Mid	J.O. @ Max.	"B"	Total Movement	System Width
CTR-100	1/2" (13)	1" (25)	4 1/2" (114)	3 5/16" (84)	4" (102)	7 5/8" (194)
CTR-200	1/2" (13)	2" (51)	4 1/2" (114)	3 5/16" (84)	4" (102)	8 5/8" (219)
CTR-300	1/2" (13)	3" (76)	4 1/2" (114)	3 5/16" (84)	4" (102)	9 5/8" (244)

Note: Minimum And Maximum Values Are After Movement Occurs. Mid Point Value Is The Recommended Size Of Opening At Installation.

PROJECT NAME:
-

PROJECT LOCATION:
-

DRAWING DESCRIPTION:

Wabo®Contour II

DATE: 12/2020

MODEL: CTR



Information provided herein, including but not limited to, any drawing, design, photograph, graphic, or statement(s) ("Materials") are proprietary and the property of Watson Bowman Acme Corporation ("Company"). Reproduction, translation, or reduction to any electronic medium or machine readable form, in whole or part, is strictly prohibited, except for the express purpose for which it has been furnished, without prior written consent of Company. All Materials contained herein are provided by Company for information purposes only. Company reserves the right to amend or withdraw any information contained in the Materials without notice. All technical or other advice by Company, whether verbal or written, concerning products, or the use of products in specific situations ("Advice") is given by Company and is used at the Users own risk.

Watson Bowman Acme
95 Pineview Drive Amherst, NY 14228
phone: (716) 691-7566 fax: (716) 691-9239
www.watsonbowmanacme.com

A brand of
MBCC GROUP

REVISION NO:

SHEET NO:

1

DRAWING NO:

S10013