

Ø1/4" X 2" Concrete Sleeve Anchors w/ Washers Spaced At 18" O.C.

Fire Barrier To Be Installed With 18 Ga. Galv. Steel Cover (For Hidden Non-Accessible Areas). Or Engineered Expansion Control System (For Public Areas)

Finish Floor

Dimensional Table		
Model (4 hr)	J.O.	Depth "A"
HFG-204	2"	8 1/2"
HFG-304	3"	8 1/8"
HFG-404	4"	7 7/8"
HFG-504	5"	7 1/2"
HFG-604	6"	7 1/4"

Concrete Blockout Where Required. (See Detail "A" For Surface Mounted Condition)

Concrete Slab - 1 hr or 2 hr Rating

High Temperature Fiber Blanket Assembly

High Temperature Cloth Retainer

"A" Depth @ Install (For Reference Only)

J.O.
Nominal Opening at Installation

Typical Section
Flush Condition

Key

Nominal Opening - 2"

HFG-204

HFG-204

Hourly Rating 4hr

Horizontal FlameGuard II

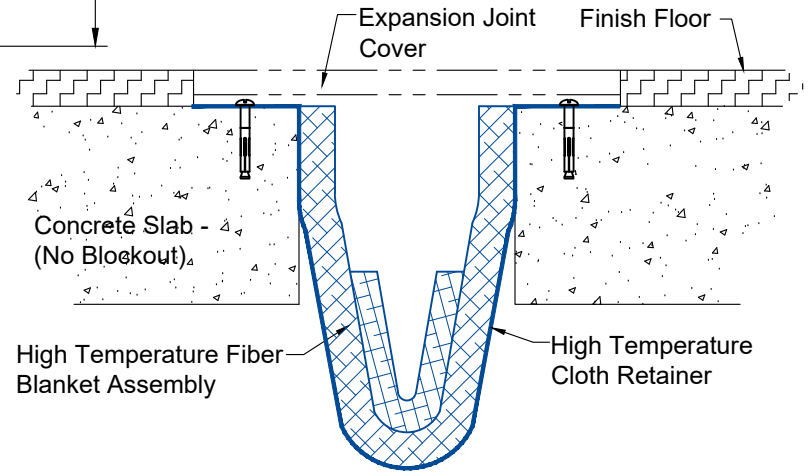

Detail A
Surface Mounted Condition

PROJECT NAME: -

PROJECT LOCATION: -

DRAWING DESCRIPTION:

Wabo®FlameGuard II

DATE: 02/04/2021

MODEL: HFG



Watson Bowman Acme
95 Pineview Drive Amherst, NY 14228
phone: (716) 691-7566 fax: (716) 691-9239
www.watsonbowmanacme.com

A brand of
MBCC GROUP

Information provided herein, including but not limited to, any drawing, design, photograph, graphic, or statement(s) ("Materials") are proprietary and the property of Watson Bowman Acme Corporation ("Company"). Reproduction, translation, or reduction to any electronic medium or machine readable form, in whole or part, is strictly prohibited, except for the express purpose for which it has been furnished, without prior written consent of Company. All Materials contained herein are provided by Company for information purposes only. Company reserves the right to amend or withdraw any information contained in the Materials without notice. All technical or other advice by Company, whether verbal or written, concerning products, or the use of products in specific situations ("Advice") is given by Company and is used at the Users own risk.

REVISION NO:

2

SHEET NO:

3

DRAWING NO:

S-10003