

Wabo® Contour II - Professional Series Model(s) "CTR" 100-600C Size 800 similar Vertical Expansion Control Systems

The following installation procedure is very important and must be fully understood prior to beginning any work. To ensure proper installation and performance of expansion joint system the following actions must be completed by the installing contractor. Failure to do so will affect product warranty.

- 1) Carefully read and understand installation procedure. Contact WBA's Technical Service Department at (800) 677-4922 for product assistance.
- 2) Inspect all shipments and materials for missing or damaged components and hardware. Contact Customer Service at (800) 677-4922 with WBA's order number and invoice for prompt assistance.
- 3) Inspect substrate or adjacent construction for acceptance before beginning work. Report unacceptable construction to the project manager for scheduled repair work.
- 4) Review WBA shop drawings for project specific detailed information if Engineering services were purchased at time of order.

Standard Components



#10 x 2" Lg Phillips Head
S.S. Tek Screw
P/n: 5832



PVC Gasket
P/n: 2838

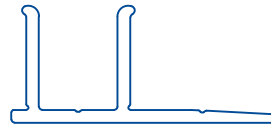

Base Extrusion
P/n: 11862

Components shown below vary in size depending on model of system

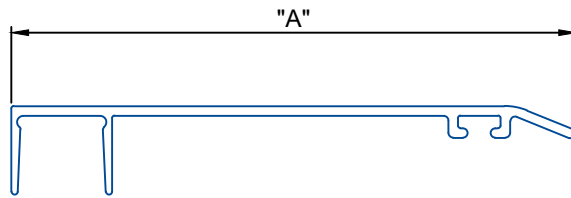

Anodized Aluminum Face Extrusion
(Refer to Chart for size and P/N's)

Model	"A"	P/n
CTR-100C	4 17/32"	11856
CTR-200C	4 17/32"	11856
CTR-300C	4 17/32"	11856
CTR-400C	6 1/32"	11863
CTR-500C	6 1/32"	11863
CTR-600C	6 1/32"	11863

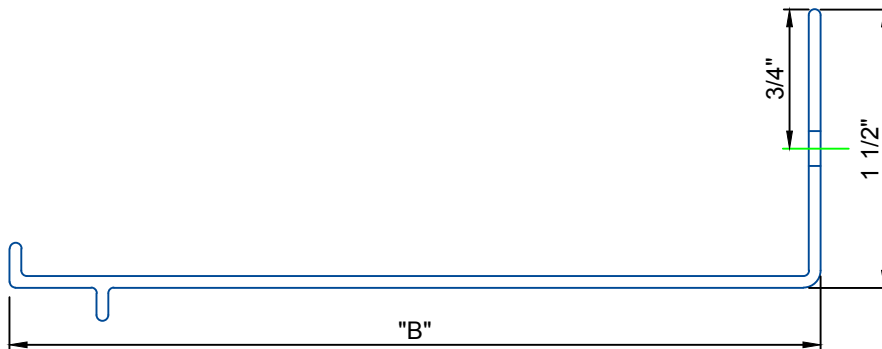

Anodized Aluminum Corner Slide Plate
(Refer to Chart for size and P/N's)

Model	"B"	P/n
CTR-100	4 3/8"	11857
CTR-200	4 3/8"	11857
CTR-300	4 3/8"	11857
CTR-400	8 1/8"	11864
CTR-500	8 1/8"	11864
CTR-600	8 1/8"	11864

DOW CORNING 795 GREY

Sheet
1
of 3

Watson Bowman Acme Corp.
95 Pineview Drive Amherst, NY 14228
phone: (716) 691-7566 fax: (716) 691-9239
website: www.wbcorp.com

Installation procedure: CTR 100C-600C Contour sys

Watson Bowman Acme Corp. reserves the right to amend or withdraw any information contained herein without notice and will not be responsible for any inaccuracy or ambiguity of any information contained herein.

Installation Procedure

Sheet

2
of 3

Watson Bowman Acme Corp.
95 Pineview Drive Amherst, NY 14228
phone: (716) 691-7566 fax: (716) 691-9239
website: www.wbacorp.com

Installation procedure: CTR 100C-600C Contour sys

Watson Bowman Acme Corp. reserves the right to amend or withdraw any information contained herein without notice and will not be responsible for any inaccuracy or ambiguity of any information contained herein.

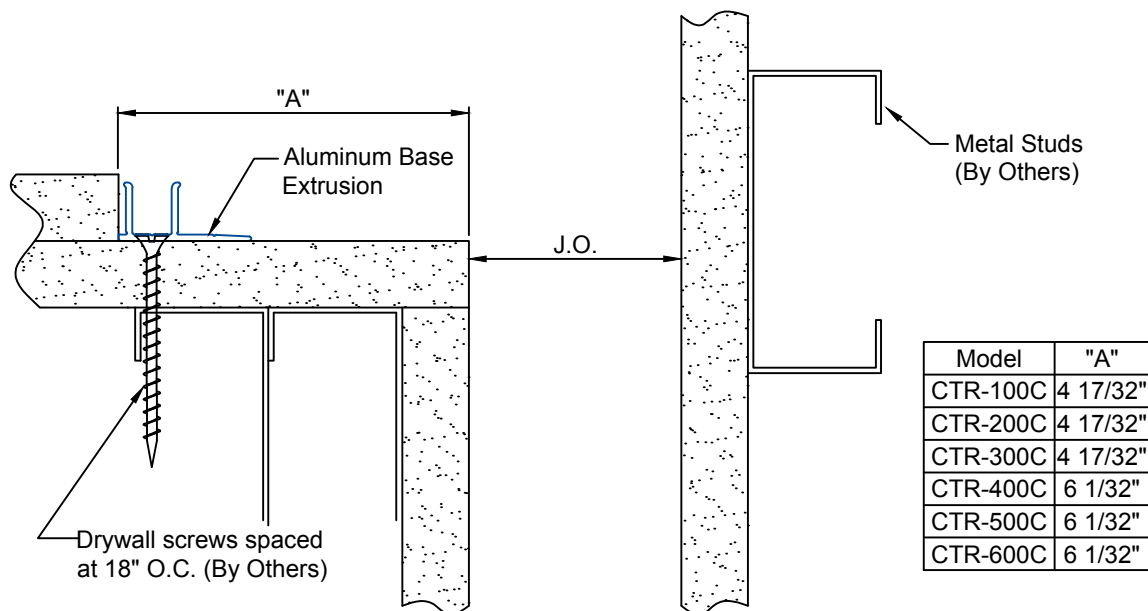

- 1 Position Aluminum Base Extrusion flush with Joint Opening. Field drill holes through the base extrusion and metal stud spaced at 18" O.C. Once the holes have been drilled, fasten base extrusion to wall with drywall screws (By Others).

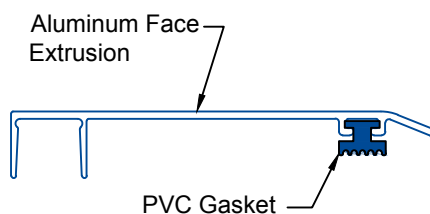

- 2 Cut PVC Gasket material to length and slide the gasket into groove on the Aluminum Face Extrusion.

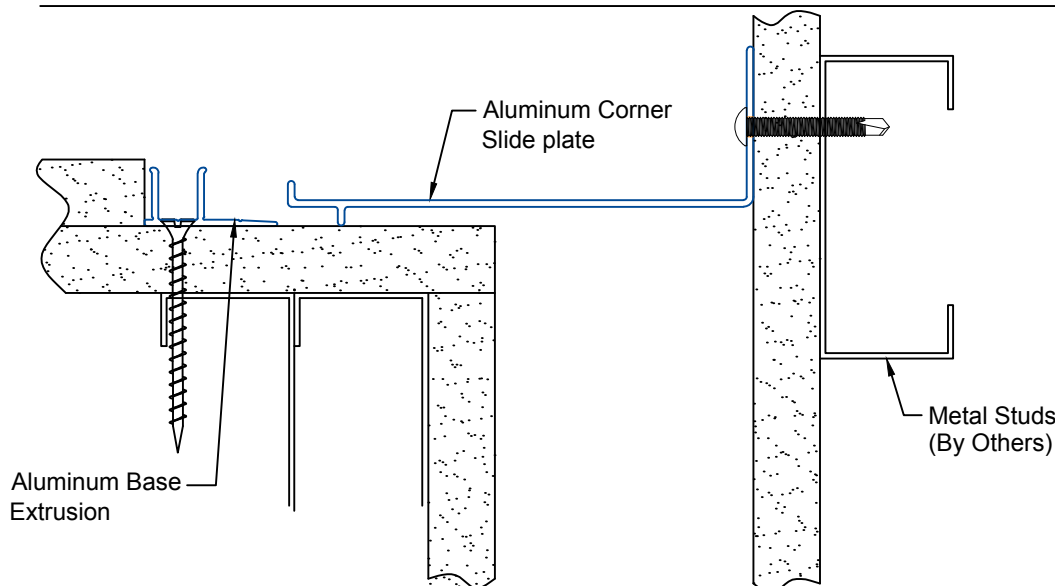

- 3 Position Aluminum Corner Slide Plate against the wall structure. After Corner slide plate location has been marked, fasten slide plate against wall with S.S. Tek Screw (P/n:5832).

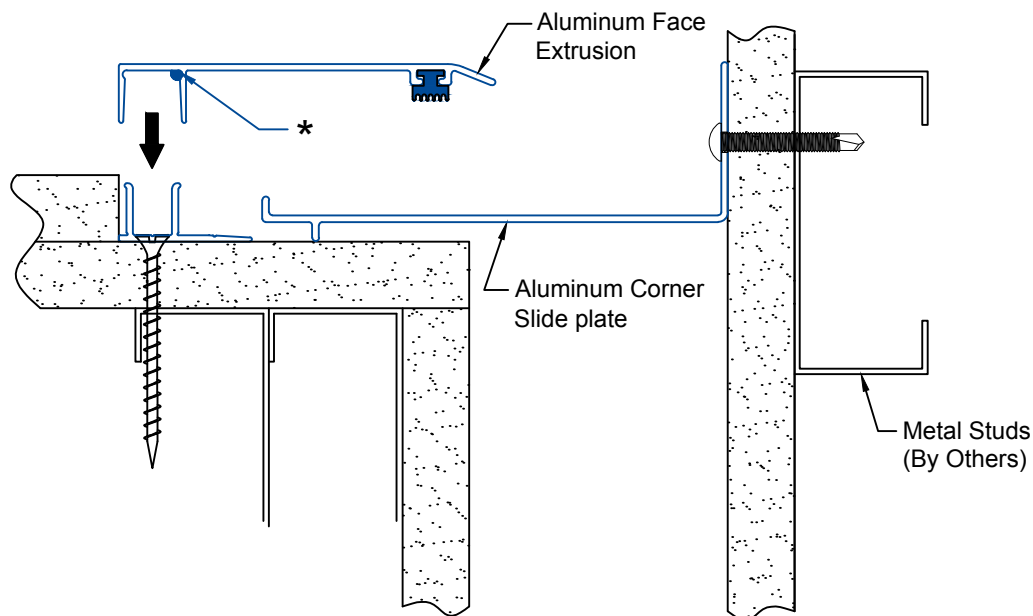

4

* Apply Continuous Bead (start 1.2" from either end) of Dow Corning 75 Grey Sealant Adhesive(WBA Part No. 3050 where indicated).

Align Aluminum Face Extrusion with Gasket material in front of Base extrusion. Using the palm of your hand or rubber mallet, gently tap Aluminum Face extrusion onto the Aluminum base extrusion. When installing, exercise care not to damage face extrusion.

Sheet
3
of 3

Watson Bowman Acme Corp.
95 Pineview Drive Amherst, NY 14228
phone: (716) 691-7566 fax: (716) 691-9239
website: www.wbcorp.com

Installation procedure: CTR 100C-600C Contour sys

Watson Bowman Acme Corp. reserves the right to amend or withdraw any information contained herein without notice and will not be responsible for any inaccuracy or ambiguity of any information contained herein.