



Installation Procedure

Watson Bowman Acme 95 Pineview Drive Amherst, NY 14228

phone: (716) 691-7566 fax: (716) 691-9239

www.watsonbowmanacme.com

Information provided herein, including but not limited to, any drawing, design, photograph, graphic, or statement(s) ("Materials") are proprietary and the property of Watson Bowman Acme (Company). Reproduction, translation, or reduction to any electronic medium or machine readable form, in whole or part, is strictly prohibited, except for the express purpose for which it has been furnished, without prior written consent of Company. All Materials contained herein are provided by Company for information purposes only. Company reserves the right to amend or withdraw any information contained in the Materials without notice. All technical or other advice by Company, whether verbal or written, concerning products, or the use of products in specific situations ("Advice") is given by Company and is used at the Users own risk.

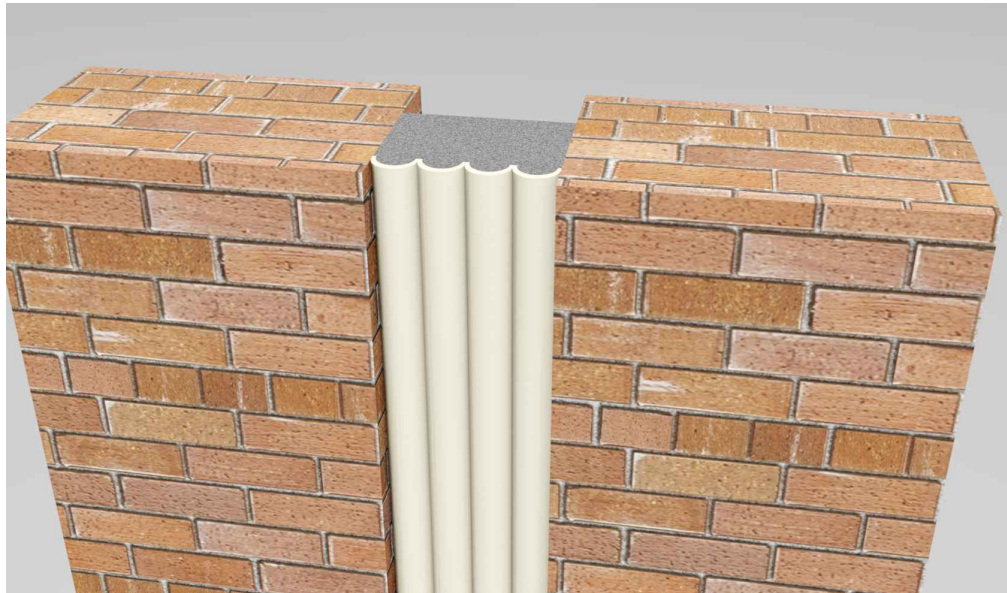

Wabo[®] SeismicWeatherSeal "SWS" Vertical Expansion Control Systems

The following installation procedure is very important and must be fully understood prior to beginning any work. To ensure proper installation and performance of expansion joint system the following actions must be completed by the installing contractor. **Failure to do so will affect product warranty.**

- 1) Carefully read and understand installation procedure. Contact WBA's Technical Service Department at (800) 677-4922 for product assistance.
- 2) Inspect all shipments and materials for missing or damaged components and hardware. Contact Customer Service at (800) 677-4922 with WBA's order number and invoice for prompt assistance.
- 3) Inspect substrate or adjacent construction for acceptance before beginning work. Report unacceptable construction to the project manager for scheduled repair work.
- 4) Review WBA shop drawings for project specific detailed information if Engineering services were purchased at time of order.

STANDARD COMPONENTS

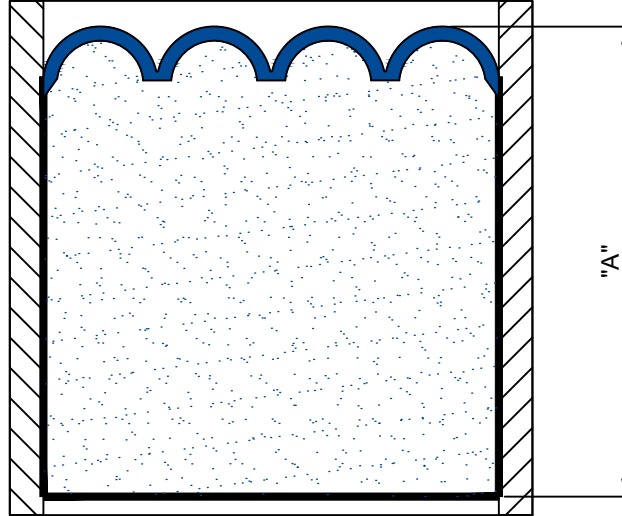

Wabo@SeismicWeather Seal (SWS)
Refer to chart below for size and part number

Model	P/N for Seal	Joint Opening	"A"	Length
SWS-100	70001	1"	1 ³ / ₄ "	6 ¹ / ₂ ' (2M)
SWS-150	70005	1 1/2"	2 ¹ / ₄ "	6 ¹ / ₂ ' (2M)
SWS-200	70009	2"	2 ¹ / ₂ "	6 ¹ / ₂ ' (2M)
SWS-250	70013	2 ¹ / ₂ "	2 ³ / ₄ "	6 ¹ / ₂ ' (2M)
SWS-300	70017	3"	3 ¹ / ₄ "	6 ¹ / ₂ ' (2M)
SWS-350	70021	3 1/2"	3 ³ / ₄ "	6 ¹ / ₂ ' (2M)
SWS-400	70025	4"	4 ¹ / ₂ "	6 ¹ / ₂ ' (2M)
SWS-500	70029	5"	5 ¹ / ₂ "	6 ¹ / ₂ ' (2M)
SWS-600	70030	6"	6"	6 ¹ / ₂ ' (2M)

Standard Colors: Limestone, Sandstone, White, Deck Gray, Light Gray, Charcoal, Black

Color-match Silicone Sealant Available

Installation procedure: SWS SeismicWeatherSeal system
Information provided herein, including but not limited to, any drawing, design, photograph, graphic, or statement ("Materials") are proprietary and the property of Watson Bowman Acme ("Company"). Reproduction, translation, or reduction to an electronic medium, or machine-readable form, in whole or in part, is strictly prohibited, except for the express purpose for which it has been furnished, without prior written consent of Company. All Materials contained herein are provided by Company for information purposes only. Company reserves the right to amend or withdraw any information contained in the Materials without notice. All technical or other advice by Company, whether verbal or written, concerning products, or the use of products in specific situations ("Advice") is given by Company and is used at the Users own risk.



CLEAN AND PREPARE JOINT SUBSTRATE

Concrete:

- Prior to beginning work, installer shall inspect and verify that the joint is clean, sound and will provide an appropriate surface (depth) for the installation of the Wabo®SeismicWeatherSeal. Installer shall verify that the joint is uniform and that any spalls are repaired using proper materials and methods.
- Joint faces must be parallel.
- Joint substrate must be dry, and cleaned by wiping with solvent.

Metal:

- All metal must be dry and cleaned by wiping with solvent.
- Ensure that there is no rust or loose paint on metal substrates before installation.

INSTALLATION PROCEDURE

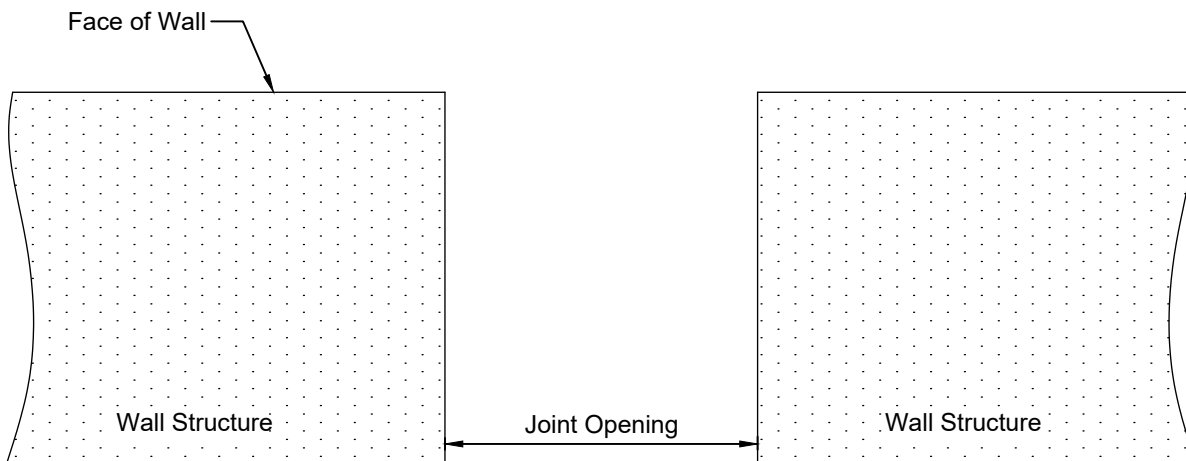

1

Solvent wipe Face of Substrate in Joint Opening.

Prior to beginning work, installer shall inspect for proper wall construction and ensure that joint opening has enough depth to accept Wabo®SeismicWeatherSeal and the recommended 1/4" Recess.

Verify joint opening as called for on chart.

Important :

Do not to remove shrink wrap packaging prior to cutting Wabo®SeismicWeatherSeal for splices or transitions. Make any necessary cuts for transitions or splices **before** removing shrink wrap packaging.

All starting and ending pieces must be square to the termination point.

For directional changes please refer to Step 7 and Step 8 for instructions.

Installation procedure: SWS SeismicWeatherSeal system

Information provided herein, including but not limited to, any drawing, design, photograph, graphic, or statement(s) ("Materials") are proprietary and the property of Watson Bowman Acme ("Company"). Reproduction, translation, or reduction to any electronic medium or machine readable form, in whole or part, is strictly prohibited, except for the express purpose for which it has been furnished, without prior written consent of Company. All Materials contained herein are provided by Company for information purposes only. Company reserves the right to amend or withdraw any information contained in the Materials without notice. Technical or other advice by Company, in the verbal or written, concerning products, or the use of products in specific situations ("Advice") is given by Company and is used at the Users own risk.

Watson Bowman Acme
95 Pineview Drive Amherst, NY 14228
phone: (716) 691-7566 fax: (716) 691-9239
www.watsonbowmanacme.com

Watson
Bowman
Acme

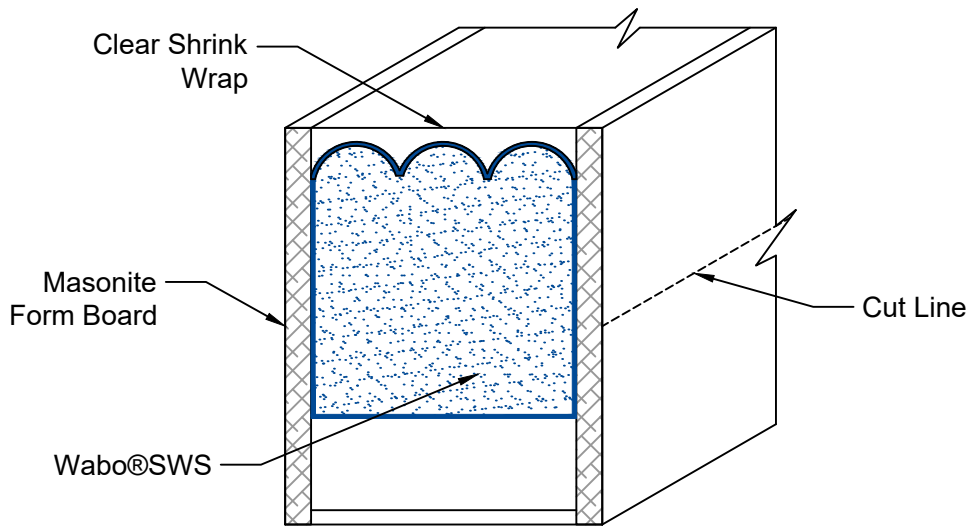

2

When ready to install Wabo®SeismicWeatherSeal, cut the shrink wrap packaging along Masonite board.
DO NOT cut along Seal coating. This is to ensure that the Silicone Face will not be cut.

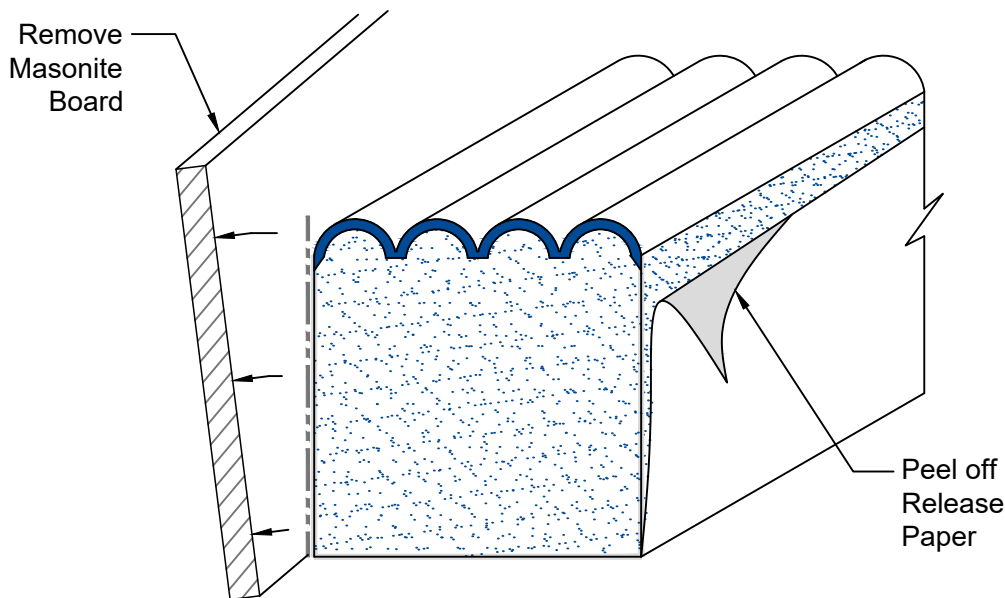

3

Remove shrink wrap packaging and masonite hardboards.
Wipe Silicone Bellows with clean damp lint free cloth.
Install the Wabo®SeismicWeatherSeal starting from the bottom to the top so that the seal is recessed 1/4" from the face of the wall.
Do not pull or stretch the SWS seal.
To help activate the pressure sensitive adhesive, use a putty knife to press the seal against the inside face of joint opening.

Note:

If pressure sensitive adhesive is hampering installation, use a spray bottle to wet the adhesive surface of Wabo®SWS. This will not impact the final sealing properties.

Installation procedure: SWS SeismicWeatherSeal system

Information provided herein, including but not limited to, any drawing, design, photograph, graphic, or statement(s) ("Materials") are proprietary and the property of Watson Bowman Acme ("Company"). Reproduction, translation, or reduction to any electronic medium or machine readable form, in whole or part, is strictly prohibited, except for the express purpose for which it has been furnished, without prior written consent of Company. All Materials contained herein are provided by Company for informational purposes only. Company reserves the right to amend or withdraw any information contained in the Materials without notice. All technical or other advice by Company, whether verbal or written, concerning products, or the use of products in specific situations ("Advice") is given by Company and is used at the Users own risk.



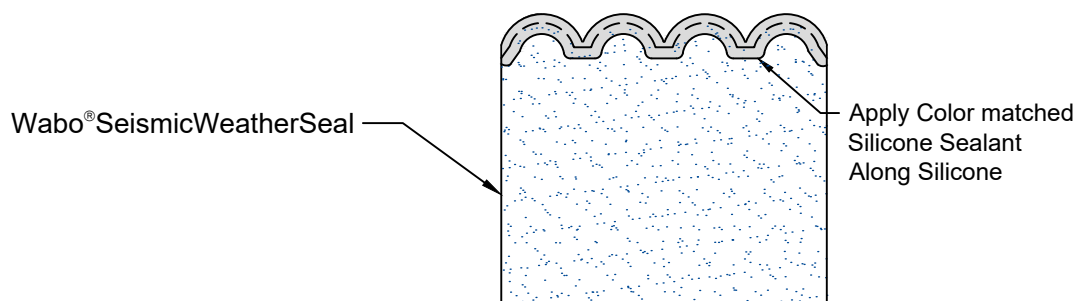

4

At all splice locations, apply a bead of Color Matched Silicone Sealant at the exposed edge of the Wabo® SeismicWeatherSeal. This is to ensure a proper bond between the factory applied Silicone on each seal stick.
Do not coat entire end faces of the SWS.

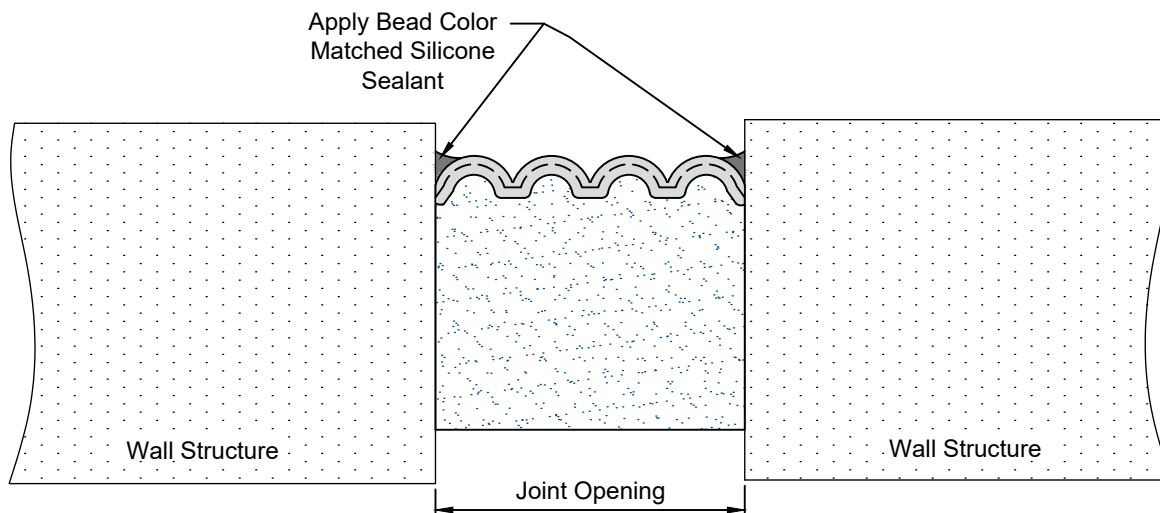

Note: At splice locations utilize Supplied Color Matched Silicone Sealant to provide a bond between seal sticks.

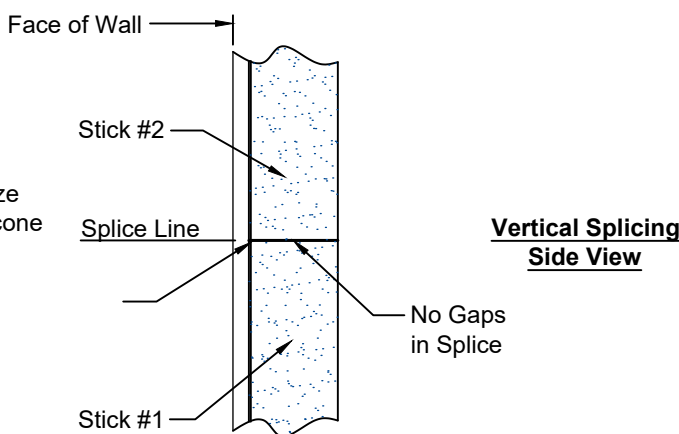

5

After the Silicone sealant has been applied, repeat installation of Wabo® SeismicWeatherSeal starting from Step 3. Make sure there are no gaps between each seal stick section during installation.

After installation of each stick, tool the splice location smooth using additional supplied silicone if necessary. This will provide a finished surface and hide the splice location as well.

Horizontal Directional Change at Face of Building

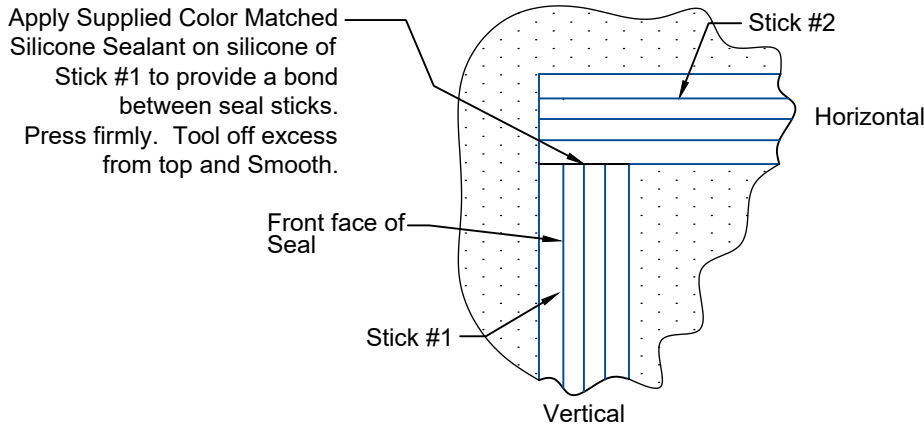

6

At a Horizontal Directional change, cut Wabo® SeismicWeatherSeal to desired length and abutt one seal to side of other.

Do Not remove shrink wrap packaging prior to cutting Wabo® SeismicWeatherSeal.

Vertical Directional Change at Top of Building Wall/Parapet

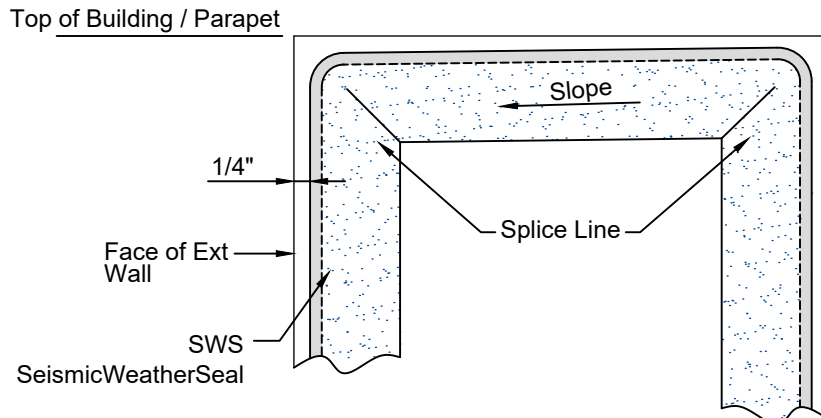

7

At parapet transition locations, cut Wabo® SeismicWeatherSeal to the desired angle of transition.

Note:

Do not to remove shrink wrap packaging prior to cutting Wabo® SeismicWeatherSeal for splices or transitions.

8

Tips:

Wabo® SeismicWeatherSeal will expand faster when hot and slower when cold. In cold temperatures, store material in a heated area for 24hrs prior to installation. In hot temperatures, **store material out of direct sunlight and not in an enclosed storage container** where temperatures may exceed 100°F.

Installation procedure: SWS SeismicWeatherSeal system

Information provided herein, including but not limited to, any drawing, design, photograph, graphic, or statement(s) ("Materials") are proprietary and the property of Watson Bowman Acme ("Company"). Reproduction, translation, or reduction to any electronic medium or machine readable form, in whole or part, is strictly prohibited, except for the express purpose for which it has been furnished, without prior written consent of Company. All Materials contained herein are provided by Company for information purposes only. Company reserves the right to amend or withdraw any information contained in the Materials without notice. All technical or other advice by Company, whether verbal or written, concerning products, or the use of products in specific situations ("Advice") is given by Company and is used at the Users own risk.